

PRODUCT INFORMATION PACKET



Model No: B2853V1
Catalog No: B2853V1

Pool Pump Motor, 1.0 HP, 1 Ph, 60 Hz, 230/115 V, 3600 RPM, P56Y Frame, DP



Regal and Century are trademarks of Regal Rexnord Corporation or one of its affiliated companies.
©2022 Regal Rexnord Corporation, All Rights Reserved. MC017097E





Nameplate Specifications

Output HP	1.0 Hp	Output KW	0.75 kW
Frequency	60 Hz	Voltage	230/115 V
Current	SF 6.5/13.0 A	Speed	3450 rpm
Service Factor	1.25	Phase	1
Duty	Continuous	Insulation Class	F
Frame	P56Y	Enclosure	Drip Proof
Thermal Protection	Thermally Protected	Ambient Temperature	50 °C
UL	Recognized	CSA	Y
Number of Speeds	1		

Technical Specifications

Electrical Type	Permanent Split Capacitor, Single Or Dual Voltage	Starting Method	Across The Line
Poles	2	Rotation	Counterclockwise Pump End
Mounting	Round	Motor Orientation	Horizontal
Drive End Bearing	Ball	Opp Drive End Bearing	Ball
Frame Material	Rolled Steel	Shaft Type	1/2 Thread
Overall Length	12.44 in	Frame Length	8.00 in
Shaft Diameter	0.625 in	Shaft Extension	.910 in
Outline Drawing	B2853V1-S01	Connection Drawing	17536729.PCX

This is an uncontrolled document once printed or downloaded and is subject to change without notice. Date Created:11/29/2022

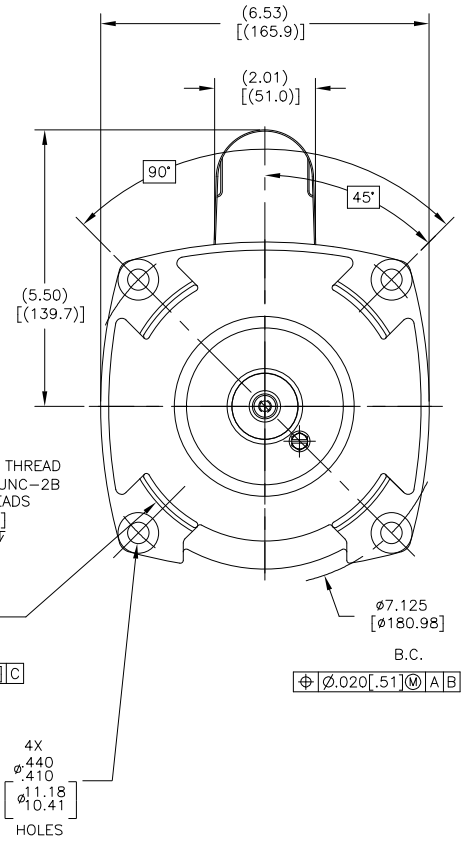
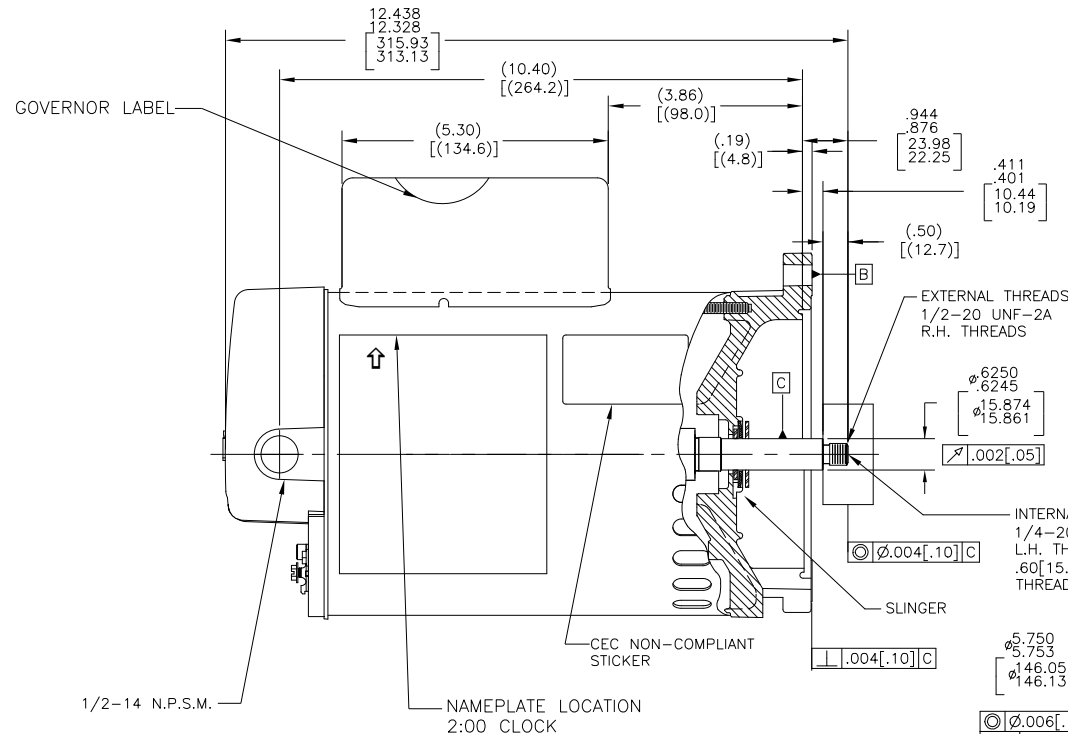
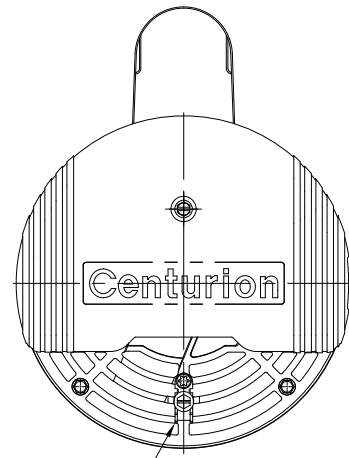

NAMEPLATE DATA	EXTERNAL CONNECTION DIAGRAM	NOTES
MODEL: F56AB45Z01 CUST PN: B2853V1 HP: 1.0 SF: 1.25 ROT: CCWPE RPM: 3450 TYPE: CX CODE: L FORM: KJM FRAME: P 56 Y VOLTS: 230/115 AMPS: SF 6.5/13.0 MAX AMPS: SF AMPS: PH: 1 HZ: 60 INS: F AMB: 50°C DUTY: CONT ENCLOSURE: DP THERMALLY PROTECTED		<ol style="list-style-type: none"> FOR THREADED SHAFT EXT. ECCENTRICITY OF THREADED PORTION OF SHAFT IS HELD WITHIN .004[.102] TOTAL GAGE READING WITH THE INDICATOR ON O.D. OF GROUND RING GAGE AS SHOWN. THE GAGE BEING STATIONARY WITH RESPECT TO THE ROTOR. END PLAY NOT TO EXCEED .010[.254] MEASURED WITH NO THRUST. ALL DIMENSIONS SHOWN IN PARENTHESIS ARE REFERENCE DIMENSIONS. FINISH PAINT TO BE BLACK. 1.24 SF HP CONNECTED FOR 230V.DUAL VOLTS MOTOR SEE CONNECTION DIAGRAM TO CHANGE VOLTS TO 115V. THRUST. CTQ REQUIREMENT SEE EP000105-008 RoHS & REACH REQUIREMENT SEE EP000014.

PERFORMANCE CURVE	APPROVED SAMPLE		
SS0097396	---		
UL COMPONENT	CSA		
FILE#	CCN#	FILE#	GUIDE#
E25022	XEWR2/8	LR4642	4211-0
CUSTOMER	DISTRIBUTION		

CRITICAL TO QUALITY CHARACTERISTICS(CTQs) (P) PROCESS (E) ENGINEERING (A) APPLICATION (R) REGULATORY (L) LIFE	DRAWING REVISION: ECR-0218054 ECO DESCRIPTION: SEE ECR	REVISION BY: HAIKUA ZHANG APPROVED BY: TRISTIA ZHAO DATE: 05-24-2022	TOLERANCES UNLESS OTHERWISE SPECIFIED DEC. INCH mm ANGLE .X ±0.1 [±3] .XX ±0.02 [±0.5] .XXX ±0.005 [±0.13] .XXXX ±0.0005 [±0.013] REMOVE BURRS & BREAK SHARP EDGES .003/.015 [08.38] CORNER FILLETS .02 [5] MACHINED SURFACES 125/32 mm SHOWN IN [BRACKETS]	DRAWN BY: Y.LIU DATE: 03-15-2016 APPROVED BY: B.SHEN DATE: 03-15-2016 REFERENCE:	REGAL™ Regal Beloit America, Inc. DESCRIPTION: MODEL-CFHP-56FR OUTLINE MATERIAL: - PROCESS/FINISH: - SIZE DWG NO: C B2853V1 SHEET: 1
	COPYRIGHT REGAL BELOIT AMERICA, INC. ALL RIGHTS RESERVED. PROPRIETARY AND CONFIDENTIAL INFORMATION - THIS DOCUMENT IS THE PROPERTY OF REGAL BELOIT AMERICA, INC. (OWNER) AND CONTAINS OWNER'S PROPRIETARY INFORMATION. ANY REPRODUCTION OR OTHER FIRM RECEIVING IT IS DENIED. BY RECEIVING IT, TO AGREE THAT IT, AND/OR ANY PART OF IT, SHALL NOT BE DISCLOSED TO ANY PERSON, CORPORATION OR OTHER ENTITY, DUPLICATED, AND/OR USED, EXCEPT AS EXPRESSLY APPROVED IN WRITING IN ADVANCE BY OWNER. THIS DOCUMENT SHALL BE RETURNED TO OWNER UPON REQUEST. IT MAY BE SUBJECT TO CERTAIN RESTRICTIONS UNDER APPLICABLE EXPORT CONTROL LAWS AND REGULATIONS.				